



**Disclaimer:**

Queensland Digital Cadastral Data Base  
Based on or combine data provided by the State of Queensland (Department of Environment and Resource Management) [2010]. In consideration of the State permitting use of this data you acknowledge and agree that the State gives no warranty in relation to the data (including accuracy, reliability, completeness, currency to suitability) and accepts no liability (including without limitation, liability in negligence) for any loss, damage or costs (including consequential damage) relating to any use of the data. Data must not be used for direct marketing or be used in breach of the privacy laws.

General  
The Infrastructure Data shown on this map has been provided by Council and/ or the State of Queensland. In this regard, Campbell Higginson Town Planning makes no guarantees, either expressed or implied as to the completeness, accuracy or correctness of the data nor accepts any liability arising from any incorrect, incomplete information contained within.

**Legend:**

-  Property Boundary
-  Priority Infrastructure Area

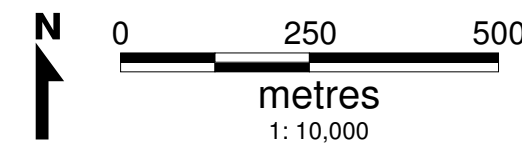

# TOWN OF YARAKA

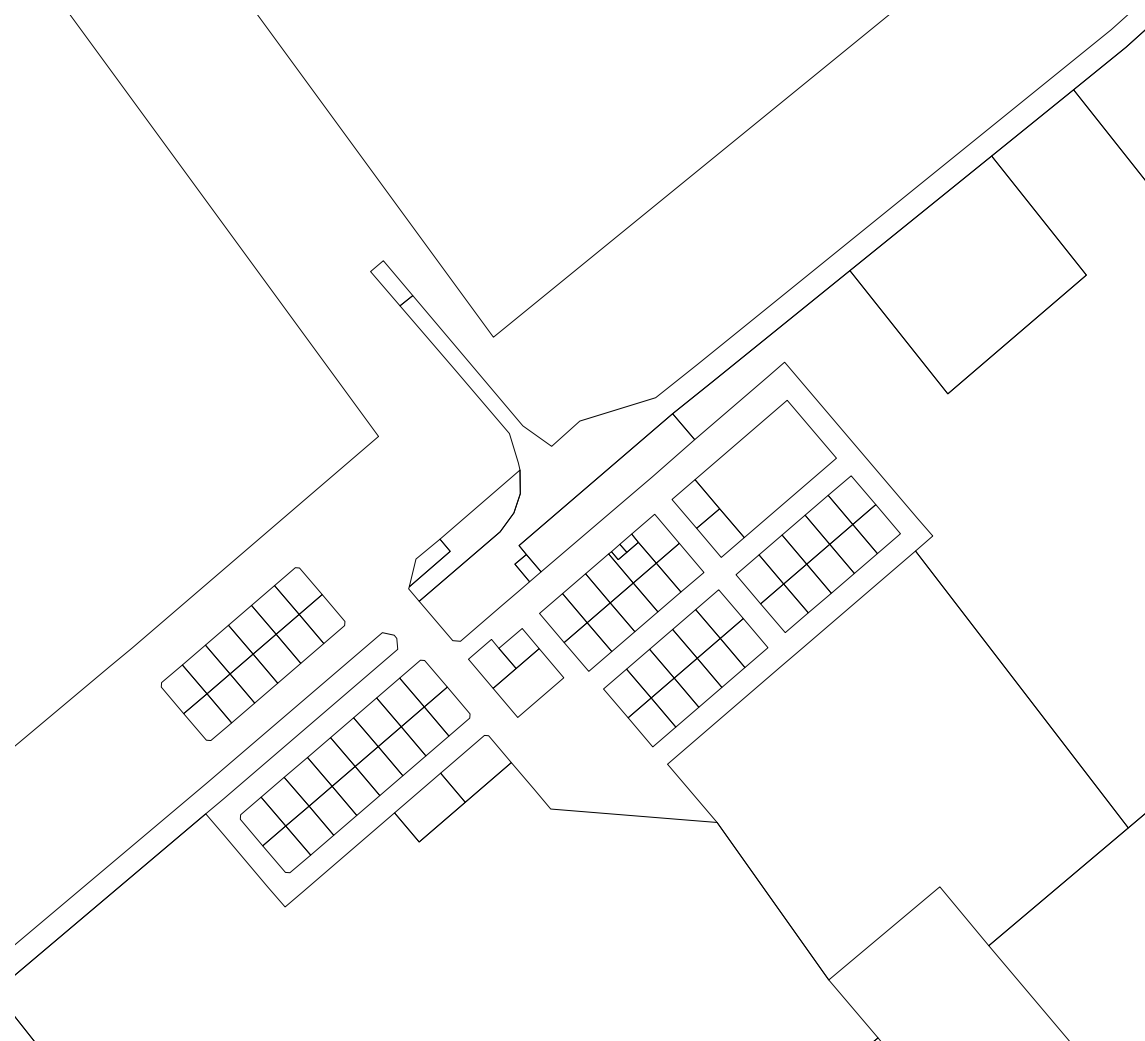

# TOWN OF EMMET

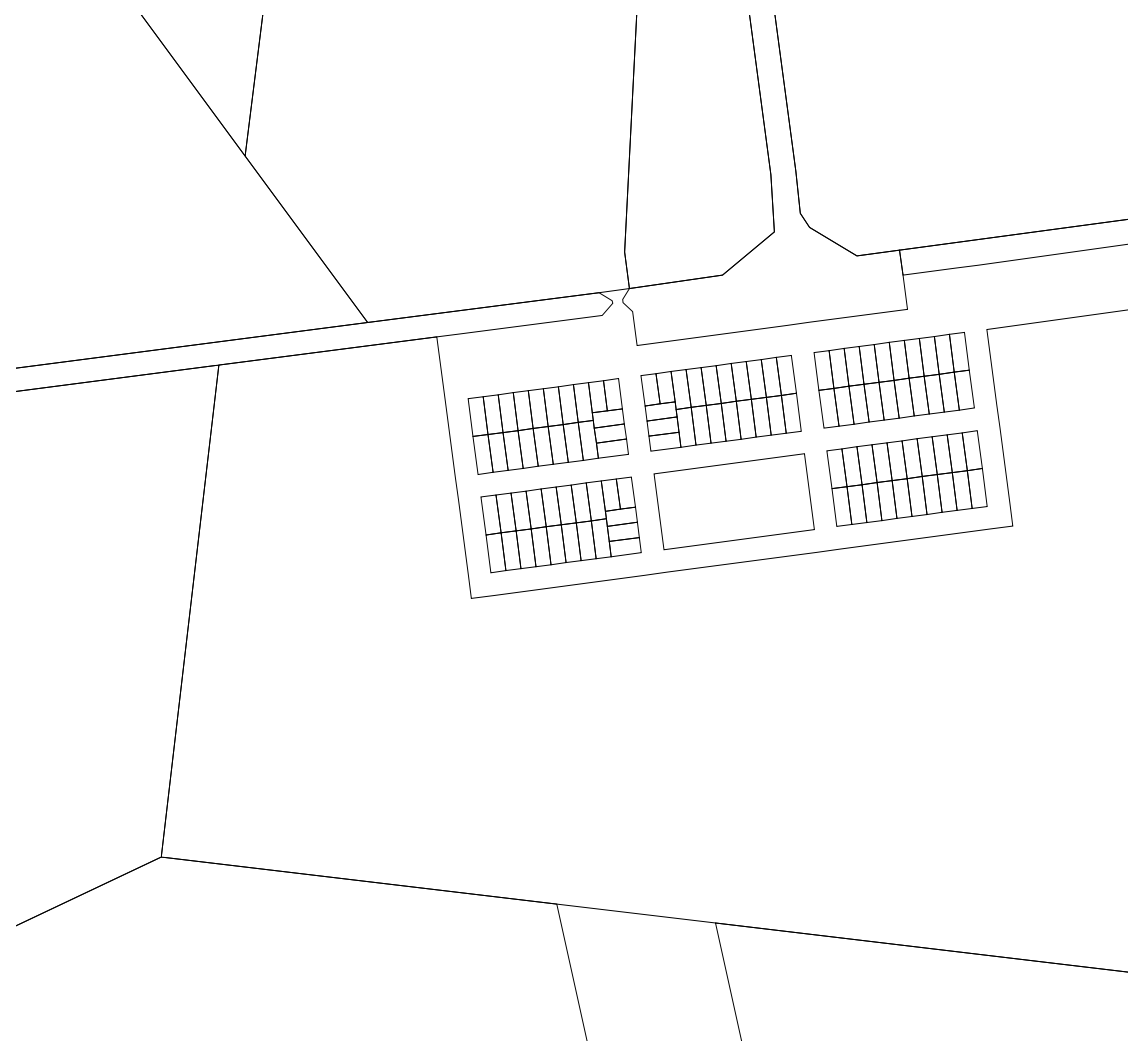

**Amendments:**

© Campbell Higginson Town Planning Pty Ltd 2003 - 2012  
Copyright protects this publication. Campbell Higginson Town Planning has no objection to this material being reproduced, made available online or electronically but only if it is recognized as the owner of the copyright and this material remains unaltered.

## ISISFORD SHIRE COUNCIL PRIORITY INFRASTRUCTURE AREA

### TOWNS OF YARAKA AND EMMET

Drawn by: <b>S.G.S.</b>	Drawing No:
Date: <b>02 - 03 - 12</b>	<b>SHEET 2</b>
Ref: <b>18PIA2</b>	

**DRAFT**